

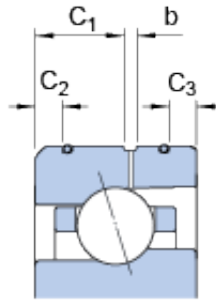

Air Suspension Bearing Co., Ltd

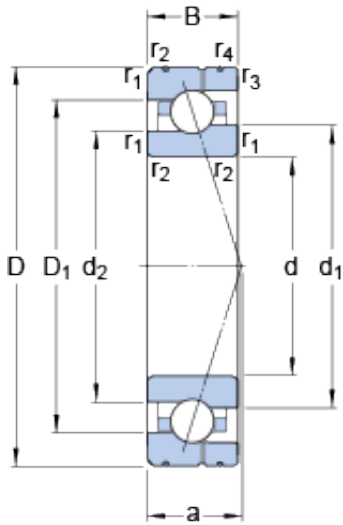

70 mm x 110 mm x 20 mm SKF 7014 ACE/HCP4AL angular contact ball bearings

Bearing No. 7014 ACE/HCP4AL

7014 ACE/HCP4AL Bearing 2D drawings and 3D CAD models

Size	110x70x20 mm
Bore Diameter	110 mm
Outer Diameter	70 mm
Width	20 mm
d	70 mm
D	110 mm
B	20 mm
d ₁	84.3 mm
d ₂	81.6 mm
D ₁	95.32 mm
b	1.9 mm
C ₁	10.9 mm
C ₂	3.4 mm
C ₃	3.4 mm
r _{1,2} - min.	1.1 mm
r _{3,4} - min.	0.6 mm
a	31.2 mm
d _a - min.	76 mm
d _b - min.	76 mm
D _a - max.	104 mm
D _b - max.	105.8 mm
r _a - max.	1 mm
r _b - max.	0.6 mm
d _n	86.5 mm



Air Suspension Bearing Co., Ltd

Basic dynamic load rating - C	22.5 kN
Basic static load rating - C ₀	17.3 kN
Fatigue load limit - P _u	0.735 kN
Limiting speed for grease lubrication	18500 r/min
Limiting speed for oil lubrication	29000 mm/min
Ball - D _w	9.525 mm
Ball - z	25
G _{ref}	8.2 cm ³
Calculation factor - e	0.68
Calculation factor - Y ₂	0.87
Calculation factor - Y ₀	0.38
Calculation factor - X ₂	0.41
Calculation factor - Y ₁	0.92
Calculation factor - Y ₂	1.41
Calculation factor - Y ₀	0.76
Calculation factor - X ₂	0.67
Preload class A - G _A	200 N
Preload class B - G _B	610 N
Preload class C - G _C	1220 N
Calculation factor - f	1.09
Calculation factor - f ₁	0.99
Calculation factor - f _{2A}	1
Calculation factor - f _{2B}	1.03
Calculation factor - f _{2C}	1.06
Calculation factor - f _{HC}	1.01
Preload class A	159 N/micron
Preload class B	238 N/micron



Air Suspension Bearing Co., Ltd

Preload class C	311 N/micron
d_1	84.3 mm
d_2	81.6 mm
D_1	95.32 mm
C_1	10.9 mm
C_2	3.4 mm
C_3	3.4 mm
$r_{1,2}$ min.	1.1 mm
$r_{3,4}$ min.	0.6 mm
d_a min.	76 mm
d_b min.	76 mm
D_a max.	104 mm
D_b max.	105.8 mm
r_a max.	1 mm
r_b max.	0.6 mm
d_n	86.5 mm
Basic dynamic load rating C	22.5 kN
Basic static load rating C_0	17.3 kN
Fatigue load limit P_u	0.735 kN
Attainable speed for grease lubrication	18500 r/min
Attainable speed for oil-air lubrication	29000 r/min
Ball diameter D_w	9.525 mm
Number of balls z	25
Reference grease quantity G_{ref}	8.2 cm ³
Preload class A G_A	200 N
Static axial stiffness, preload class A	159 N/ μ m
Preload class B G_B	610 N
Static axial stiffness, preload class B	238 N/ μ m
Preload class C G_C	1220 N



Air Suspension Bearing Co., Ltd

Static axial stiffness, preload class C	311 N/ μ m
Calculation factor f	1.09
Calculation factor f_1	0.99
Calculation factor f_{2A}	1
Calculation factor f_{2B}	1.03
Calculation factor f_{2C}	1.06
Calculation factor f_{HC}	1.01
Calculation factor e	0.68
Calculation factor (single, tandem) Y_2	0.87
Calculation factor (single, tandem) Y_0	0.38
Calculation factor (single, tandem) X_2	0.41
Calculation factor (back-to-back, face-to-face) Y_1	0.92
Calculation factor (back-to-back, face-to-face) Y_2	1.41
Calculation factor (back-to-back, face-to-face) Y_0	0.76
Calculation factor (back-to-back, face-to-face) X_2	0.67
Mass bearing	0.56 kg