

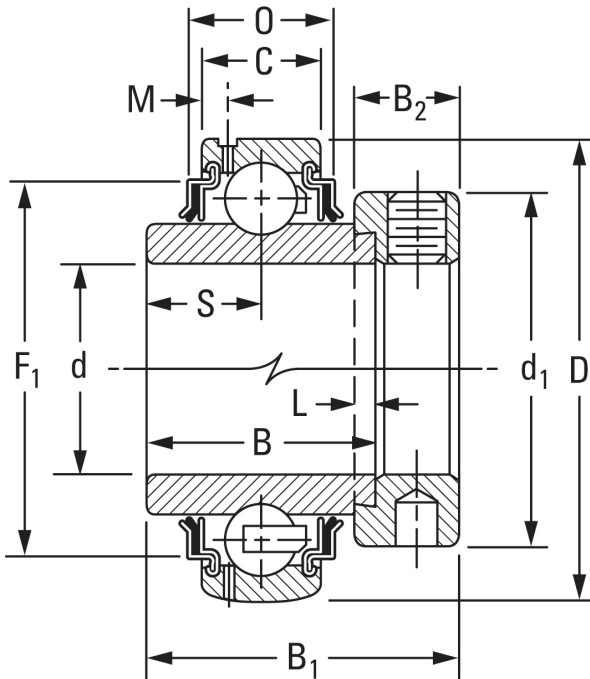

# Air Suspension Bearing Co., Ltd

20,6375 mm x 52 mm x 34,92 mm Timken  
G1013KRRB deep groove ball bearings



G1013KRRB Bearing 2D drawings and 3D CAD models

Bearing No. G1013KRRB

Shaft Size d	13/16 in
Bore Type	Cylindrical bore
Bearing Type	Ball Bearing
Material	Bearing Steel
Lubrication Type	Relubricatable
O.D. Type	Spherical OD
Dimension M	0.152 in
Dimension B2	0.531 in
Series	Industrial
Weight	0.50 lb
Sub Series	G1...KRRB
Seal Type	Shroud Seal
Outside Diameter D	2.047 in
Inner Ring Width B	34.92 mm
Outside Ring Width C	15.000 mm
Radius r	0.6 mm
Center of Bearing from End S	17.5 mm
Dimension S1	26.9 mm
Set Screw Size	1/4-20
Number of Set Screws	2
Angle between Set Screws	90 °
Dimension B1	1.748 in
Static Load Rating	1750 lbf
Dynamic Load Rating	3490 lbf