

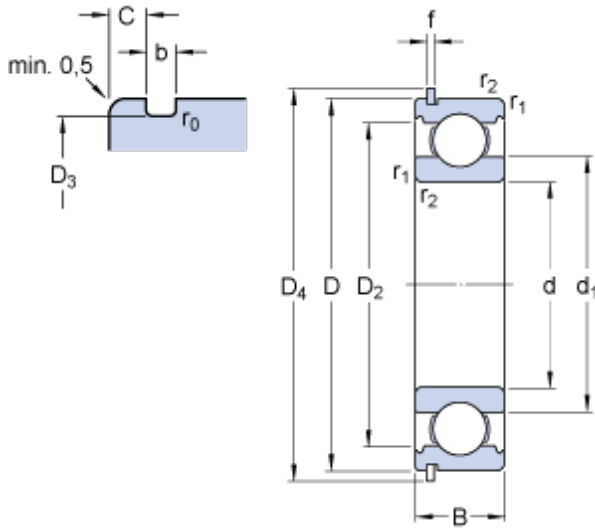

# Air Suspension Bearing Co., Ltd



17 mm x 47 mm x 14 mm SKF 6303 NR deep groove ball bearings

Bearing No. 6303 NR

|   |             |
|---|-------------|
| Size                                      | 47x17x14 mm |
| Bore Diameter                             | 47 mm       |
| Outer Diameter                            | 17 mm       |
| Width                                     | 14 mm       |
| d   | 17 mm       |
| D   | 47 mm       |
| B   | 14 mm       |
| d <sub>1</sub>                            | 26.52 mm    |
| D <sub>2</sub>                            | 39.58 mm    |
| D <sub>3</sub>                            | 44.6 mm     |
| D <sub>4</sub>                            | 52.7 mm     |
| b   | 1.35 mm     |
| C   | 2.46 mm     |
| f   | 1.12 mm     |
| r <sub>0</sub>                            | 0.4 mm      |
| r <sub>1,2</sub> - min.                   | 1 mm        |
| d <sub>a</sub> - min.                     | 22.6 mm     |
| D <sub>a</sub> - max.                     | 41.4 mm     |
| D <sub>b</sub> - min.                     | 54 mm       |
| b <sub>a</sub> - min.                     | 1.5 mm      |
| C <sub>a</sub> - max.                     | 3.58 mm     |
| r <sub>a</sub> - max.                     | 1 mm        |
| Basic dynamic load rating - C             | 14.3 kN     |
| Basic static load rating - C <sub>0</sub> | 6.6 kN      |

6303 NR Bearing 2D drawings and 3D CAD models



## Air Suspension Bearing Co., Ltd

|                                |             |
|--------------------------------|-------------|
| Fatigue load limit - $P_u$     | 0.275 kN    |
| Reference speed                | 34000 r/min |
| Limiting speed                 | 22000 r/min |
| Calculation factor - $k_r$     | 0.03        |
| Calculation factor - $f_0$     | 12          |
| Mass bearing                   | 0.12 kg     |
| $d_1$                          | 26.52 mm    |
| $D_2$                          | 39.58 mm    |
| $D_3$                          | 44.6 mm     |
| $D_4$                          | 52.7 mm     |
| $r_0$ max.                     | 0.4 mm      |
| $r_{1,2}$ min.                 | 1 mm        |
| $d_a$ min.                     | 22.6 mm     |
| $D_a$ max.                     | 41.4 mm     |
| $D_b$ min.                     | 54 mm       |
| $b_a$ min.                     | 1.5 mm      |
| $C_a$ max.                     | 3.58 mm     |
| $r_a$ max.                     | 1 mm        |
| Basic dynamic load rating C    | 14.3 kN     |
| Basic static load rating $C_0$ | 6.55 kN     |
| Fatigue load limit $P_u$       | 0.275 kN    |
| Calculation factor $k_r$       | 0.03        |
| Calculation factor $f_0$       | 12          |
| Snap ring                      | SP 47       |