

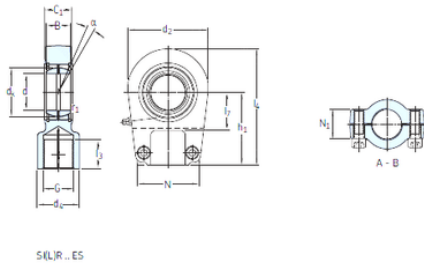

Air Suspension Bearing Co., Ltd



SKF SIR 120 ES plain bearings

Bearing No. SIR 120 ES

SIR 120 ES Bearing 2D drawings and 3D CAD models

Bore Diameter	120 mm
d	120 mm
d2 max.	343 mm
d4 max.	175 mm
dk	160 mm
h1	310 mm
l3 min.	135 mm
l4 max.	493 mm
l7 min.	138 mm
r1 min.	1 mm
B	85 mm
C1 max	90,5 mm
N max	257 mm
N1 max	86 mm
Thread (G)	M 130x3 Tolerance 6H
Angle	6 °
Weight	84 Kg
Basic dynamic load rating (C)	950 kN
Category	Bearings
Inventory	0.0
Manufacturer Name	SKF
Minimum Buy Quantity	N/A
Weight / Kilogram	90
Product Group	B04286
d ₂ max.	343 mm
G	M 130x3



Air Suspension Bearing Co., Ltd

C_1 max.	90.5 mm
h_1	310 mm
	6 °
d_k	160 mm
d_4 max.	175 mm
l_3 min.	135 mm
l_4 max.	493 mm
l_7 min.	138 mm
N max.	257 mm
N_1 max.	86 mm
r_1 min.	1 mm
Size bolt with internal hexagon	M 24
Tightening torque bolt with internal hexagon	670 N · m
Basic dynamic load rating C	950 kN
Basic static load rating C_0	2450 kN
Specific dynamic load factor K	100 N/mm ²
Material constant K_M	330
Mass rod end	76.6 kg