

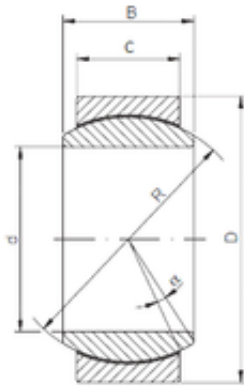

Air Suspension Bearing Co., Ltd

15 mm x 26 mm x 12 mm ISO GE 015 ECR
plain bearings



Bearing No. GE 015 ECR

Size	15x26x12 mm
Bore Diameter	15 mm
Outer Diameter	26 mm
Width	12 mm
d	15 mm
D	26 mm
B	12 mm
C	9 mm
R	22 mm
Angle	8 °

GE 015 ECR Bearing 2D drawings and 3D CAD models