

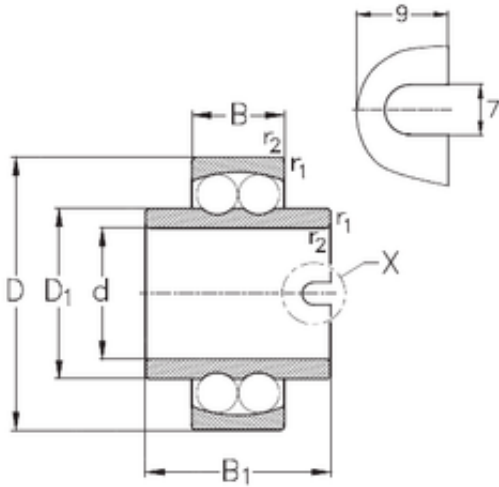

Air Suspension Bearing Co., Ltd

45 mm x 85 mm x 58 mm NKE 11209 self aligning ball bearings

Bearing No. 11209



11209 Bearing 2D drawings and 3D CAD models

Size	45x85x58 mm
Bore Diameter	45 mm
Outer Diameter	85 mm
Width	58 mm
d	45 mm
D	85 mm
B	58 mm
C	19 mm
r1 min.	1,1 mm
r2 min.	1,1 mm
D1	57,7 mm
Weight	0,78 Kg
Basic dynamic load rating (C)	23,5 kN
Basic static load rating (C0)	8,2 kN